



MovinCool® Climate Pro® K Series

MovinCool Climate Pro K36



FAMILY FEATURES

- Sleek, modern design
- Wrap around bumper system protects against scratches & dents
- Built-in exhaust flanges with protective grille
- Condensate tank hidden behind easy-open access door
- Convenient cord storage cubby on rear of unit
- Connectivity enabled

PERFORMANCE

Ambient Operating Range	65-95°F
Cooling Capacity	36,000 Btu/h
Supply Airflow h/m/l cfm	920/880/840
Max Supply/Cold Duct Length	40 feet
Exhaust Airflow h/m/l cfm	1390/990 (H/L)
Max Hot/Exhaust Duct Length	60 feet
Sound Level High (w/out duct)	70 dB

APPLICATION

Voltage @ 60Hz	208/230
Recommended Breaker Size (A)	30
Amps (A)	19.9
Min/Max Voltage	198-253
Power Cord Gauge	12AWG-3 Core
Power Cord Length	6 feet
Plug Receptacle Requirement 	NEMA 6-30P

SHIPPING/LOGISTICS/ HANDLING/QUALITY

	Shipping	Out of Carton
Weight (lbs.)	570	454
Height (in.)	58	53
Width (in.)	34	31
Depth (in.)	59	55

RoHS Restriction of Hazardous Substances Standard compliant
UL 60335 and UL 60335-2-40 compliant

A Carrier Company



spot-coolers.com
800-367-8675

©2021 Carrier. All Rights Reserved.

ACCESSORIES

NOZZLE APPLICATION

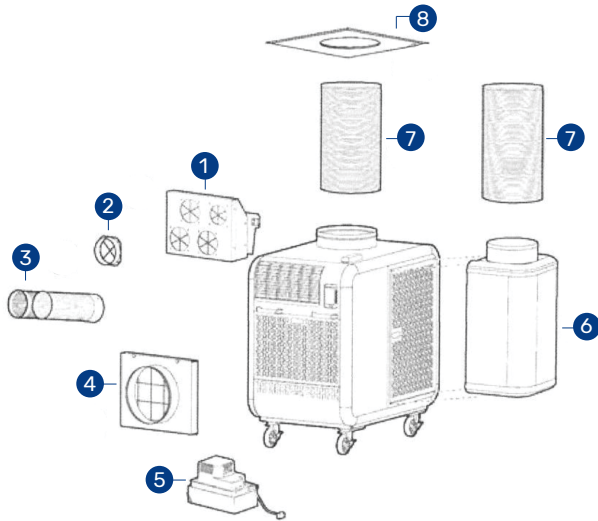

#	Part No.	Description
1	481769-0290	6" Base, Four Hole
2	481170-0490	6" Quick Connect Flange**
3	484209-0490	6" Nozzle**
4	484350-1330	Plenum Evaporator Air
5	484789-0240	Condensate Pump Kit, 230v
6	484350-1230	Plenum Condenser Air
7	LAY45820-0010	Flexible Air Duct, 8' by 16"
8	484490-1040	Ceiling Tile Kit, 16-in hole, metal
*	HDK-16	2' x 2' Ceiling Tile with 7' of 16" Flex Duct

* Not Pictured

** Sold Individually

DUCT HOSE APPLICATION

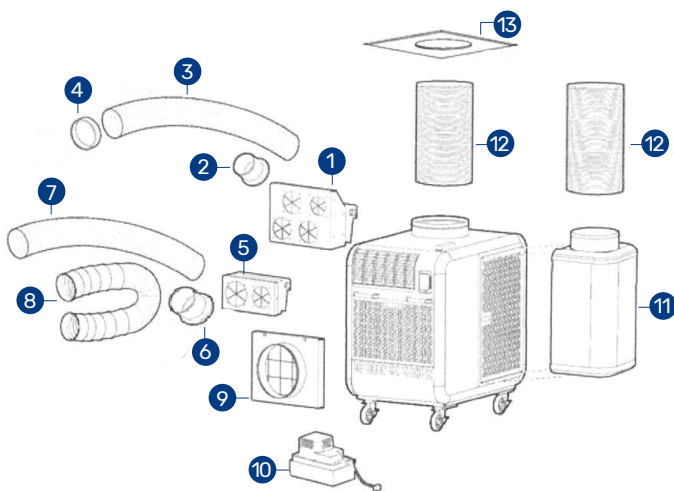

#	Part No.	Description
1	481769-0290	6" Base, Four Hole
2	481170-0460	6" Flange Ext. Duct
3	481744-0030	6" Self-Supported Duct**
4	481851-0210	6" Trim Ring**
5	481769-0300	8" Base, Two Hole
6	481170-0470	8" Flange Ext. Duct
7	LA481744-0430	8" Self-Supported Duct**
8	LAY45810-0030	8" Flexible Air Duct**
9	484350-1330	Plenum Evaporator Air
10	484789-0240	Condensate Pump Kit, 230v
11	484350-1230	Plenum Condenser Air
12	LAY45820-0010	Flexible Air Duct, 8' by 16"
13	484490-1040	Ceiling Tile Kit, 16-in hole, metal
*	HDK-16	2' x 2' Ceiling Tile with 7' of 16" Flex Duct

* Not Pictured

** Sold Individually