

315L undercarriages 303-9301

Right and left frame assemblies w/o carbody.

GENERAL DIMENSIONS (in/mm)		315L	LOWER WEIGHT (lb/kg)	315L
Overall Length	A	156.3/3971	With 600 mm Shoes	12440/5643
Track on Ground	B	124.6/3166		
Overall Height	C	35.8/889	LOAD CAPACITY (lb/kg)	
Frame Height	D	23.0/585	Light Duty	63,000/28600
Idler Centerline	E	16.1/409	Medium Duty	51,000/23400
Sprocket Centerline	F	16.3/414	Heavy Duty	43,000/19500
Tread Diameter	G	19.96/507		
Pitch Diameter	H	25.38/644.6		
Track Shoe Width (Double Grouser)	I	600 mm		
Number of Track Rollers Per Frame:		7		
Number of Carrier Rollers Per Frame:		2		
** Includes full length track guiding guards				

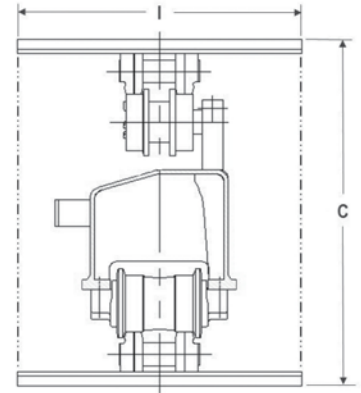
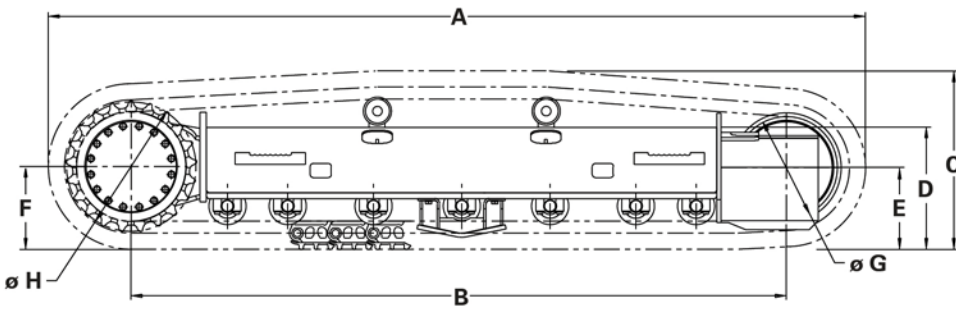

The information contained in this specification sheet is for preliminary design layout only. A detailed drawing in 2D or 3D format should be requested for final design. All dimensions shown in inches (mm) and are standard except as noted.

Application Parameters

- Max Tractive Effort: 44,630 lb/ 20,244 kg
- Working Hydraulic pressure: 5000 psi/ 345 bar
- Final Drive Type: L&S GFT 50
- Final Drive Gear Ratio: 84.2:1
- Motor Displacement (CC): 92/60
- Max Travel Speed: < 3.3 mph/5.3kph
- Parking Brake Torque: 17500 N-m
- Parking Brake Release Pressure: 75 psi / .517 MPa

Definitions

Suggested maximum machine Gross Vehicle Weight (GVW) for different machine classes.

- Light Duty: Little or no movement and little impact (e.g., mobile crushers and pavers).
- Medium Duty: Moderate frequency of movement and moderate impact (e.g., blast hole drills).
- Heavy Duty: High frequency of movement and high impact (e.g., feller bunchers).

<https://oemsolutions.cat.com/StandardProducts>

Caterpillar does not accept liability for product if used for an application outside the product parameters.

